

A96

2MP Outdoor Mini Dome with D/N, Adaptive IR, Superior WDR, SLLS, Fixed Lens



- 2 Megapixel
- Day & Night with Superior Low Light Sensitivity and Adaptive IR LED
- Fixed Lens with f2.8mm/F2.0
- Superior WDR
- H.265 Compression
- Wide Angle

► Specifications

Device

Product Type	Mini Dome
Maximum Resolution	2MP
Application Environment	Outdoor
Image Sensor	Progressive Scan CMOS
Sensor Size	1/2.7 "
Day / Night	Yes
Low Light Sensitivity	Superior
Mechanical IR Cut Filter	Yes
IR LED	Adaptive IR LED
IR Working Distance	20m
Horizontal Resolution (TV Lines)	1100 TVL

Lens

Focal Length	Fixed focal, f2.8mm
Aperture	F2.0
Iris	Fixed iris

Focus	Fixed focus
Lens Mount	Board mount
Horizontal Viewing Angle	90°
Viewing Angle Adjustment	Pan: ±120°, Tilt: 30°-90°

Video

Compression	H.265, H.264, MJPEG
Maximum Frame Rate vs. Resolution	30 fps at 1920 x 1080 30 fps at 1280 x 720 30 fps at 720 x 480 30 fps at 640 x 480 30 fps at 320 x 240
Multi-Streaming	Simultaneous dual streams based on two configurations
Bit Rate	28Kbps - 12Mbps (per stream)
Bit Rate Mode	Constant, Variable
Wide Dynamic Range	Superior WDR (120 dB)
Image Enhancement	Digital Image Stabilizer (DIS, EIS)
Digital Noise Reduction	2D + 3D DNR
On-Screen Graphics	Yes
Built-in Analytics	Tampering Detection
Image Orientation	Flip, Mirror, Rotation (Corridor mode)

Network

Network Protocol & Service	IPv4/v6, TCP, UDP, DHCP, PPPoE, HTTP, HTTPS, DNS, DDNS, NTP, RTP, RTSP, RTCP, SMTP, FTP, IGMP, ICMP, ARP, Bonjour, UPnP, QoS, SNMP
Ethernet Port	1 x Ethernet (10/100 Base-T), RJ-45 pigtail connector

Integration

ONVIF Compliant	Yes, Profile S, Profile G, Profile T
Web Browser	IE 11

Interface

Local Storage	MicroSDHC Memory Card Slot (card not included, up to 128GB)
Operating Button	Reset Button

General

Power Source	DC 12V, PoE Class 3 (IEEE802.3af)
Power Consumption	5 W (PoE, IR on), 6 W (DC, IR on)
Weight	342g (0.754lb)
Dimensions	(Ø x H): 99mm x 64.7mm (3.9" x 2.5")
Environmental Casing	Weatherproof (IP66), Vandal proof (IK10)
Mount Type	Surface, Wall Mount, Pendant
Starting Temperature	-10°C ~ 50°C (14°F ~ 122°F)
Operating Temperature	-20°C ~ 50°C (-4°F ~ 122°F)
Approvals	CE (EN 55032 Class A, EN 55024), FCC Class A, EAC, BIS, IP66, IK10
Real-time Clock (RTC)	No

Warranty

3 Year(s). For extended warranty offering, see <http://www.acti.com/support/warranty>

► Photo Indication



- 1 Power Input
- 2 Ethernet Port
- 3 Memory Card Slot
- 4 Reset Button

► Dimension Diagram

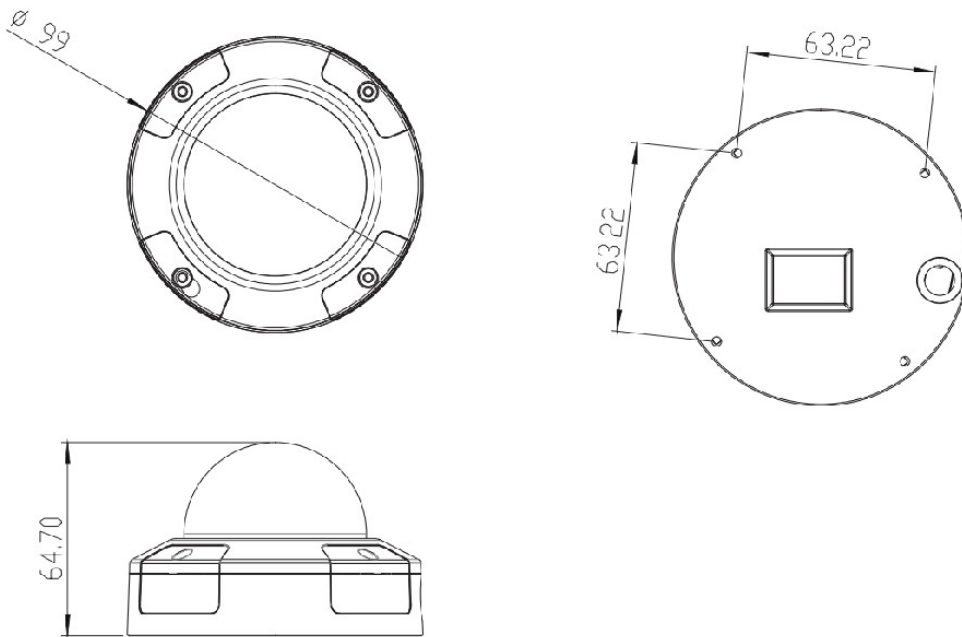

Unit: mm









Unit: mm [inch]

► Ordering Information

A96-B	2MP Outdoor Mini Dome with D/N, Adaptive IR, Superior WDR, SLLS, Fixed lens, f2.8mm/F2.0 (HOV:90°), H.265/H.264, 1080p/30fps, 2D+3D DNR, MicroSDHC, PoE/DC12V, IP66, IK10. Installation cable at the back.
A96-S	2MP Outdoor Mini Dome with D/N, Adaptive IR, Superior WDR, SLLS, Fixed lens, f2.8mm/F2.0 (HOV:90°), H.265/H.264, 1080p/30fps, 2D+3D DNR, MicroSDHC, PoE/DC12V, IP66, IK10. Installation cable at the side.

► Related Products

Mounting Accessories - Camera Mount

PMAX-0122		Straight Tube (for A71, A88, A9x,)
PMAX-0123		Extension Tube (for A71, A88, A9x,)
PMAX-0318		Wall Mount (for A88, A92, A94, A96, Z91, Z94, Z95, Z77, Z710, A61, A62, A71)
PMAX-0506		Pole Mount (for A31, A4x, E78, E9x, E9xx), supports 2" to 3" Poles
PMAX-0715		Junction Box (for A88, A92, A94, A96)
PMAX-0812		Gang Box Converter (for A88, A92, A94, A96), supports 4" Round and 4" Octagon Boxes
PMAX-0816		Converter Ring, 1.0" NPT for Third-Party Mounting Accessories, White
PMAX-1402		Mount Kit (for A91, A92, Z91, A61, A62, A71)

Note: Some mounting accessories may need additional accessories for installation. Please check www.acti.com/mountingselector for more information.

Dome Covers - Transparent Dome Cover

R701-50007		Transparent dome cover (for A92,A94,A96)
------------	---	--

Power Supply Accessories - Power Adapter

PPBX-0012		Power Adapter AC 100~240V (US), for A3x, A4x, A88, A9x, Z31, Z8x, Z9x
PPBX-0013		Power Adapter AC 100~240V (EU), for A3x, A4x, A88, A9x, Z31, Z8x, Z9x
PPBX-0014		Power Adapter AC 100~240V (UK), for A3x, A4x, A88, A9x, Z31, Z8x, Z9x