

# Power-over-Ethernet (PoE) Outdoor Housing Quick Installation Guide

## PACKAGE CONTENTS

---

The carton should contain the following items:



Housing



Bracket



Screw Pack

If any item is missing or damaged, please contact your local reseller for replacement.

**Note:** The images in this Quick Installation Guide are for reference only. Actual housing and cameras may vary.

## PARTS OVERVIEW

---

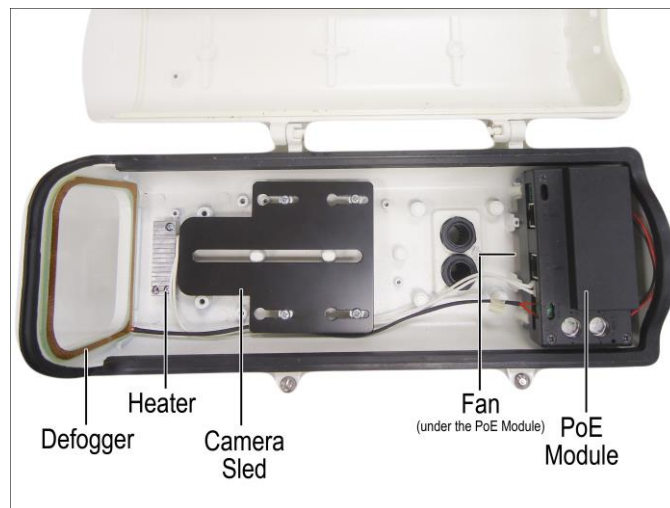

PoE Housing with Heater, Fan, and Defogger

## MOUNTING THE CAMERA

---

1. Remove the camera sled from the housing.
2. Mount the camera to the sled using the bundled screw. Examples of some camera models below:



3. Attach the camera sled back to the housing, slide and tighten the screws to fix its position.
4. Connect the cables.



## ***MOUNTING THE HOUSING AND BRACKET***

1. Attach the bracket using the bundled allen wrench screwdriver.

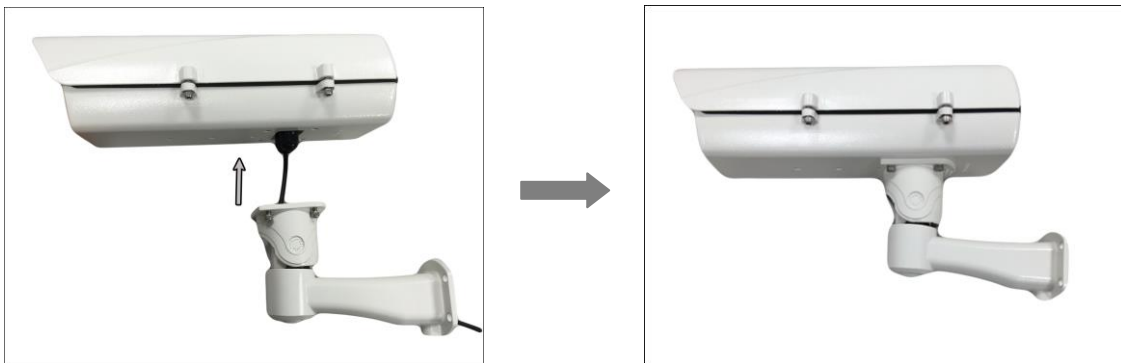

2. Loosen the bracket allen screw, adjust the tilt and pan of the housing, then tighten the allen screw to fix its position.

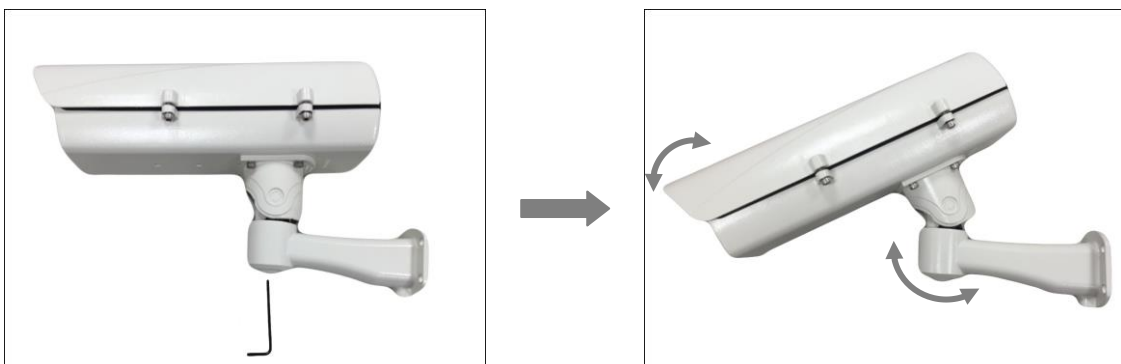

**Note:** For detailed installation instructions, please refer to the Installation Guide on our website.

## ***CONNECTING POWER***

1. Connect the Ethernet cable from the PoE switch or injector to the **PoE Input** port of the Housing.
2. Use another Ethernet cable to connect the camera to the **PoE Output** port of the Housing.

